

Teach Buvinda, Bóthar Átha Cliath, An Uaimh, Contae na Mí. C15 Y291
Buvinda House, Dublin Rd., Navan, Co.Meath. C15 Y291

Transportation - Active Travel | Projects & Asset Management
[CASE:324427]
30th July 2025

Colm Burns
Senior Development Manager
Lagan Homes Tullyallen Limited
1st Floor Block 10-4
Blanchardstown Corporate Park
Dublin D15X98N
Email colm.burns@laganhomes.com

**Letter of Consent to proceed with a planning application for proposed development at Gort Mell,
Mell/Tullyallen, Old Slane Road, Drogheda, Co. Louth: Lagan Homes Tullyallen Ltd**

Dear Colm,

Meath County Council as the body having effective control over the lands at Mell/Tullyallen, Old Slane Road, Drogheda, County Louth, identified on the attached Site Location Map 22.127.LD3002 being the lands comprised in Folios LH21116F and LH20524F, hereby consent to Lagan Homes Tullyallen Ltd making a planning application for a proposed development which forms part of a larger development/series of developments comprising original Grant of Permission 21/1283 of which 30 units are complete. Planning Ref. 24/60266 was also granted comprising 207 units. This proposed development comprises the construction of 47 No. dwellings including modifications to approved planning permission 211283/ABP-311678-21 as modified by planning permissions LRD-2360368 and LRD-2460266 and all associated and ancillary site development works. The proposals include a new roundabout at the end of the Old Slane Road at the entrance to the site as set out on the attached drawing OSR-WMC-ZZ-GF-DR-C-4105, together with 10 No. Duplex Units in one No. 3 storey block and 37 No. 2 storey houses as set out on the attached Phase 3 – Proposed Site Layout Map 22.127-OSR-JF-LD-A-3003.

If planning is granted, please note that it would be subject to the following:-

1. The applicant, Lagan Homes Tullyallen Limited, will require a future separate consent in advance of carrying out any works on the lands owned by or in the control of Meath County Council or to access any lands owned by Meath County Council which do not form part of a public road.
2. A Road Opening Licence will have to be obtained from Louth County Council for works required on the public road.

I would point out that Meath County Council gives this consent in its capacity as landowner only and not as a Roads Authority or Planning Authority, and any additional queries related to these functions should be referred to Louth County Council for matters pertaining to this application.

Yours sincerely



Una McNamara
Administrative Officer

ENC: Site Location Map 22.127.LD3001
Phase 3 – Proposed Site Layout Map 22.127-OSR-JF-LD-A-3003
Drawing OSR-WMC-ZZ-GF-DR-C-4105

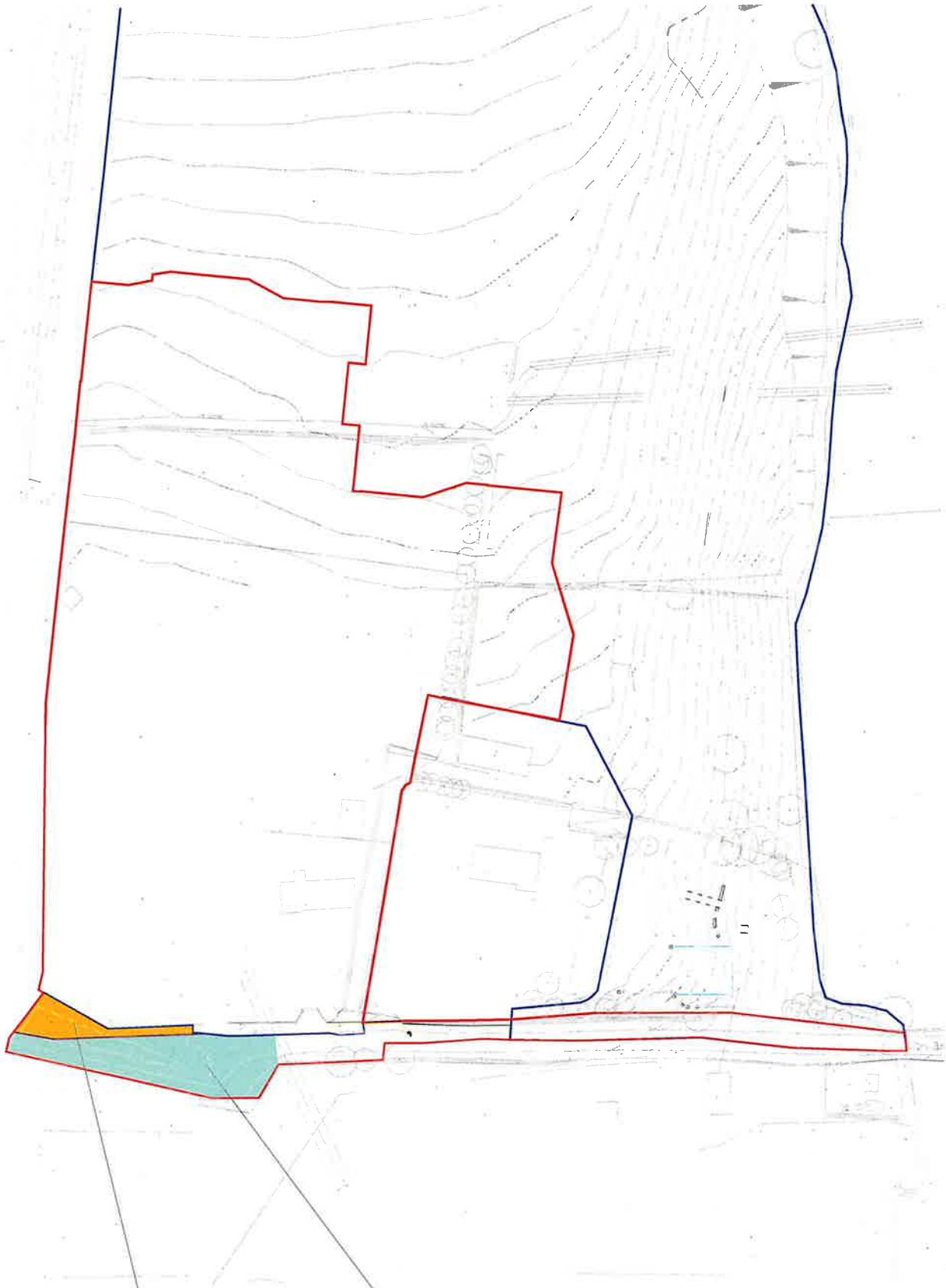

Meath County Council lands for which letter of consent is required in Folio LH21116F



Meath County Council lands for which letter of consent is required in Folio LH20524F



Ordnance Survey
X,Y = 705967, 776321
OS Ref No. 1771-B
Licence No. AR0010725

Subject Site Outlined in Red
Lands in Legal Ownership of Applicant Outlined in Blue



